

CONCUBE

WE DESIGN THE FUTURE

RAMMED EARTH

FEATURE CATALOGUE

Version 4.0



CORE PRODUCT LINE

I CONCRETE FLOORING/ WALL/CLADDING

II CONCRETE FURNITURE/LIGHTS/BASINS

III CONCRETE KITCHENS

IV RAMMED EARTH

V METAL PATINA



OVERVIEW

ABOUT RAMMED EARTH

RAMMED EARTH ENGINEERING

REFERENCE PROJECTS

RAMMED EARTH FURNITURE

RAMMED EARTH ART

ABOUT RAMMED EARTH

Rammed earth construction is a structural building method of compressing a sandy mixture into a hard sandstone-like material. **Rammed earth** walls resemble adobe **construction**. Both use soil mixed with waterproofing additives.

The **process** Making **rammed earth** involves compacting a damp mixture of sub soil that has suitable proportions of sand, gravel, clay, and stabilizer, if any into a formwork (an externally supported frame or mould).

RAMMED EARTH ENGINEERING

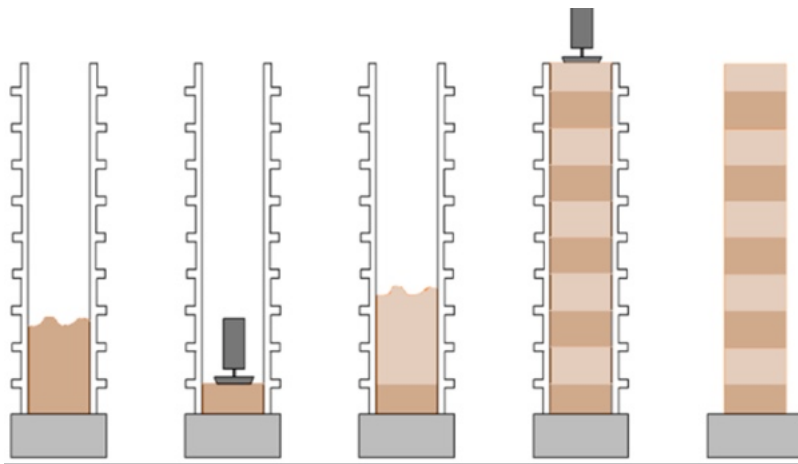

FIGURE 1.0

The RAMMED EARTH **process** involves compacting a damp mixture of soil that has suitable proportions of sand, gravel, clay, and stabilizer, if any into a formwork (an externally supported frame or mould).

Figure 1.0 shows the different step wise process of RAMMED EARTH.



REFERENCE PROJECTS





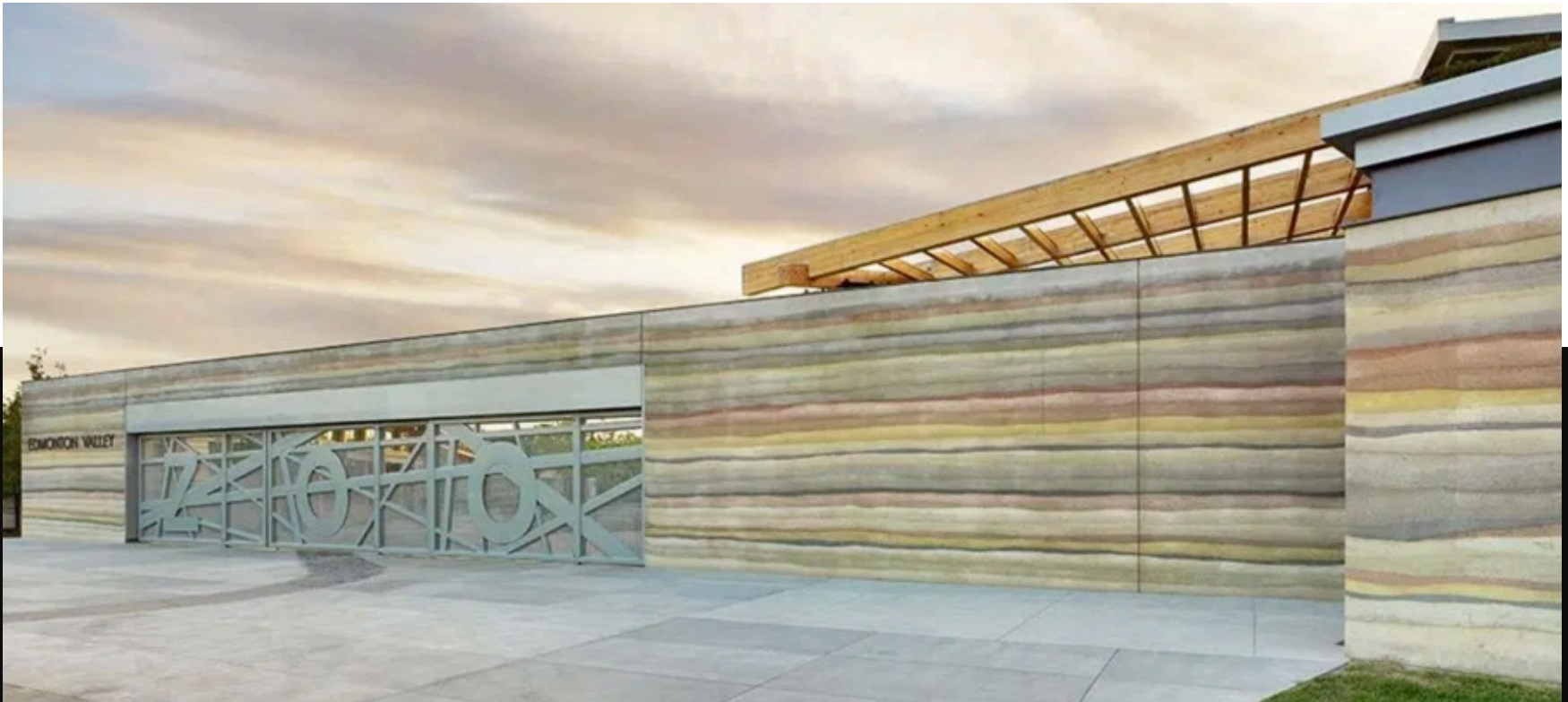

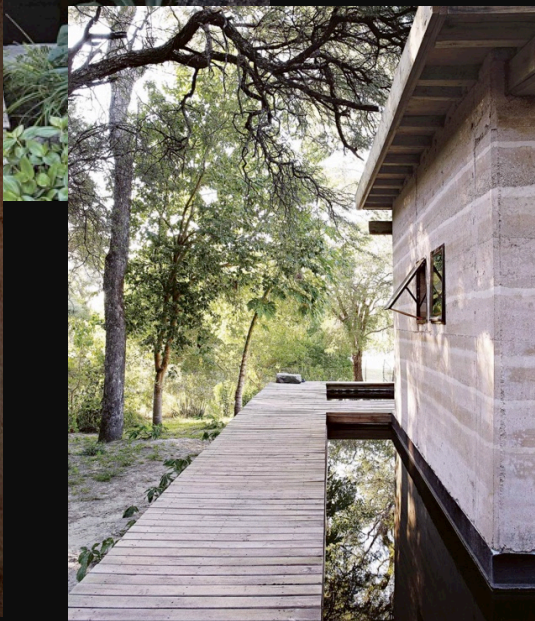
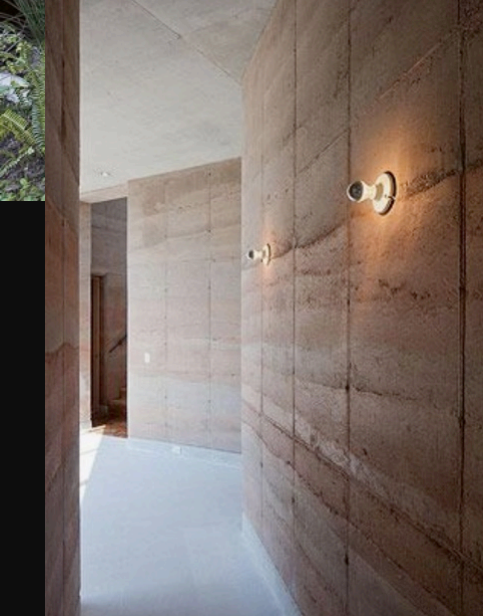

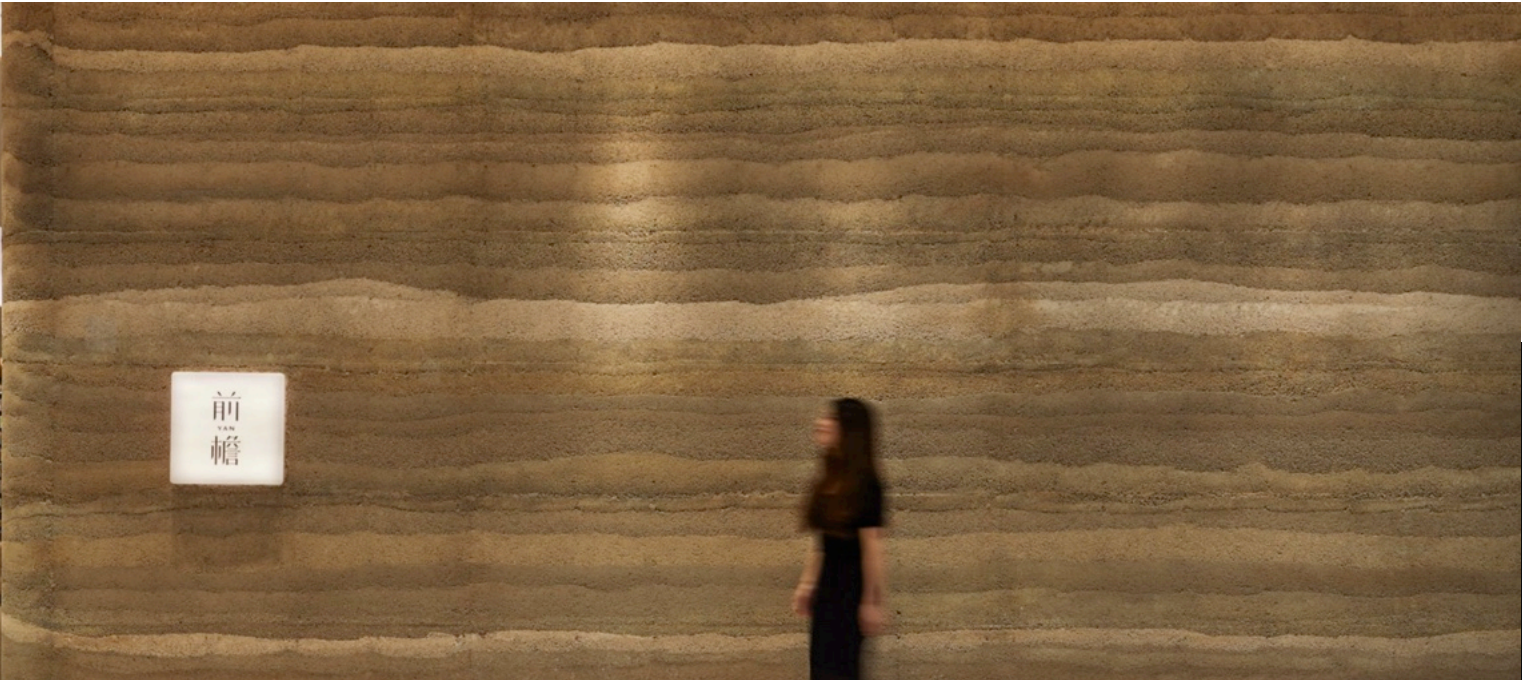



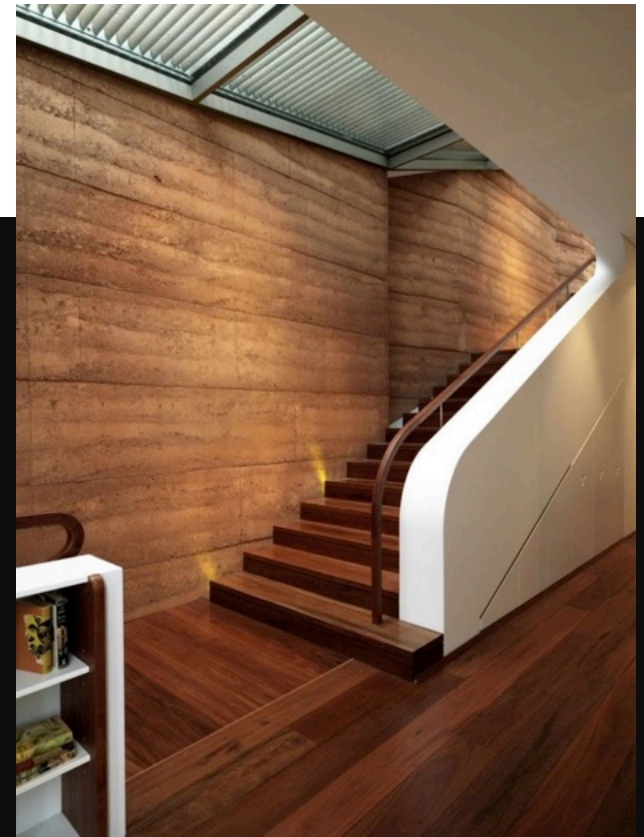



CONCCUBE



CONCCUBE







RAMMED EARTH FURNITURES









RAMMED EARTH ART





STUDIO

A-101, SOLITAIRE CORPORATE PARK,
B/S DIVYABHASKAR,
SG HIGHWAY, AHMEDBAD,
INDIA - 380 015
9 8 2 5 5 5 3 3 3 4
IMDELHIWALA@CONCCUBE.COM

THE CONCCUBE HOUSE

CONCCUBE HOUSE,G-16, GLADE ONE, NANI
DEVATI, SANAND-AHEMDABAD.
(Visit: CONTACT @STUDIO)

WORKSHOP

GHUMA, AHMEDABAD.

WWW.CONCCUBE.COM